



**kadriumdesign**™/MC

# EVOLUTION Storage System



### Support Profile

56/568402700

The structural base of the Evolution system. In lengths of up to 200" (5100mm).

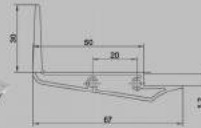

### Glass Shoe Shelf Profile

56/502704000

Aluminum profile with edge for swivel shelf. For 4mm glass (or other material) inserts. Also available for melamine shelves (56/1034044003).

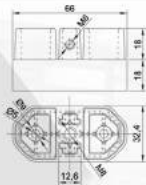

### Zamac Adaptor

56/567050000

End-piece to fix support profiles to walls and to install levels.

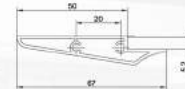

### Glass Flat Shelf Profile

56/502704000

Aluminum profile with edge for swivel shelf. For 4mm glass (or other material) inserts.

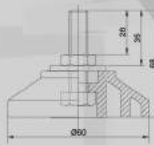

### Adjustable Leveler

56/563050000

Leveler with a 3/8" (9,5mm) adjustment.



### Oval Tube Profile

35/655404000

Profile for transversal closet pole.



### Oval Fixture

56/5630400001

Wall and ceiling fixtures.

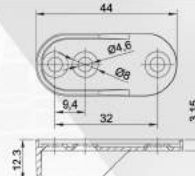

### Oval Tube Support Bracket

56/570050000

Adjustable bracket for the oval closet pole profile.

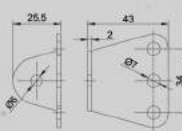

### Frontal Support Bracket

56/580040004

Stabilizes structures fixed to shelf brackets. Can also be used to support corner shelves or small elements.

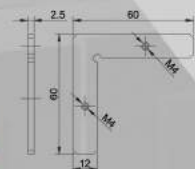

### Vertical Support Bracket

12/224360000

90 degrees bracket for support profile assembly.



### Anti Sway Bracket

56/5620500004

Stabilizes structures fixed to the shelf brackets. Less visible than the regular support brackets.

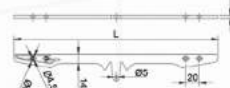

### Glass Shelf Support

56/510040350

56/510040500

13 49/64" (350mm) or 19 11/16" (500mm).



**kadriumdesign**™/MC

# EVOLUTION Luminous Shelves



**Evolution** luminous shelves can be installed in the Evolution storage system or as standard shelves within a cabinet.

Anodized aluminum finish

4mm glass inserts

LED lights

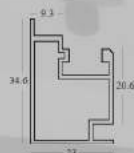

## Luminous Shelf Profile

The anodized aluminum profiles that are the core build of the luminous shelves. It holds the top and bottom glass panels as well as the LED light strips.

## LED Light Strips

Many type of LED lights are available to fit your actual lighting.



*When ordering **Evolution Luminous Shelves**, some information is required so that the shelves are custom made to perfectly fit your environment and your project; the type of lighting in the room, how many shelves are connected together, the shelves disposition in the cabinet or **Evolution System** and whether the power cord goes to a wall outlet or directly to the household AC current. The shelves will then be built accordingly and fitted with the right type of LED lights and power supply.*



For your safety, electric installations should always be made by certified professionals.

